



## 1408 SERIES CAPSULE LOW PRESSURE GAUGE MODEL:1408



### Application

1408 series capsule low pressure gauge is suitable for dry and gaseous media that does not attack copper alloy parts. It is mainly used for medical, vacuum, laboratory technology for contents measurement and filter monitoring.

### Specifications:

**Nominal sizes:**

4"

### Connection:

BSP 1/2" for 4"

### Scale Range, according to EN 837-1/5

Pressure ranges: 0 to 16/25/40/60/100/160/250/400/600/1000mbar

Vacuum range: -600/-400/-250/-160/-100/-60/-40/-25/-16 to 0 mbar

### Operating Temperature:

Ambient: -20°C..+60°C

Medium: +60°C maximum

### Material Specification:

Case and bayonet ring: AISI 304 stainless steel Window: Instrument Glass

Wetted parts: copper capsule, brass connection

Movement: brass



### Options:

NPT, BSPT or other process connection

Restrictor

Double dial range or other dial ranges

**\* 1409 series, All Stainless steel construction for 2.5",**

### DIMENSION:

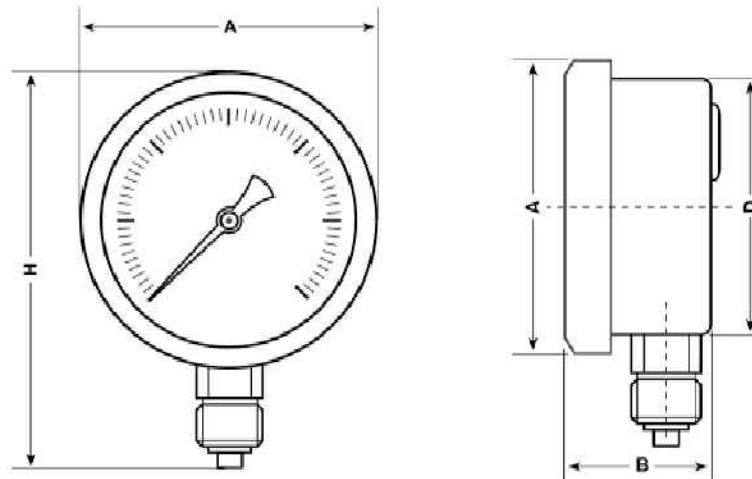

DIAL SIZE	A	H	B	D
4"	Ø110	86	49	98

dimensions are approximate and can be changed without prior notice