

BOURDON TUBE PRESSURE GAUGE



STAINLESS STEEL SERIES, DIN BAYONET RING, LIQUID FILLABLE MODEL: 1320



Applications:

- For gaseous and liquid aggressive media that are not highly viscous or crystallizable, also in aggressive ambience.
- With liquid filled version for high dynamic pressure vibration.
- Process industries including chemical plants, petrochemical refineries, pharmaceutical, food and beverage processing, offshore oil platforms, papermills, salt mines, fertilizer plants and on shipboard

Features:

- Accuracy: 1.0% full scale
- Over range protection 1.3 times max
- Liquid filled or dry
- All stainless steel
- 0-1000bar

Specifications:

Norminal size:

63mm, 100mm and 150mm

Design:

EN 837-1

Accuracy class:

63mm: 1.6

100mm and 150mm: 1.0

Scale range:

Pressure: 0-0.6 to 1000bar

Vacuum: -1bar to 0

Compound: -1 to 24bar

or other equivalent units of pressure or vacuum

Operating temperature:

Ambient: -40+60 deg C without liquid filled

-20+60 deg C with glycerin filled

Medium: +200 deg C maximum without liquid filled

+100 deg C maximum with liquid filled

Protection class: IP 66

Material:

Case: AISI 304 stainless steel

Bezel ring: AISI 304 DIN bayonet ring

Window: Laminated safety glass

Liquid filling: Dry but fillable as standard, glycerine or silicone oil fillable

Dial plate: aluminum, with pointer stop, white background, black marking for single scale, black and red marking for dual scale

Pointer: Black aluminum, micro-adjustable for 4" and 6"

Bourdon tube: AISI 316L stainless steel

< 100bar: C-type

≥100bar: helical type

Movement: AISI 304 stainless steel

Process connection: AISI 316 stainless steel, welded with gauge case

63mm with G1/4"B male

100mm and 150mm with G1/2"B male

Options:

- NPT, BSPT or other process connection thread
- Restrictor (RS)
- Special face design
- Glycerin 99.5% filled (GF)
- Silicone oil filling (SF)
- Refrigeration Scale (RF)
- Ammonia NH3 scale (AM)
- Blow-out rubber at back of 100mm and 150mm case (BO)
- Compensation oil cap for Range up to 16bar (CO)
- 160mm dial size (160)
- Toughened glass window (TG)



Dimension drawing

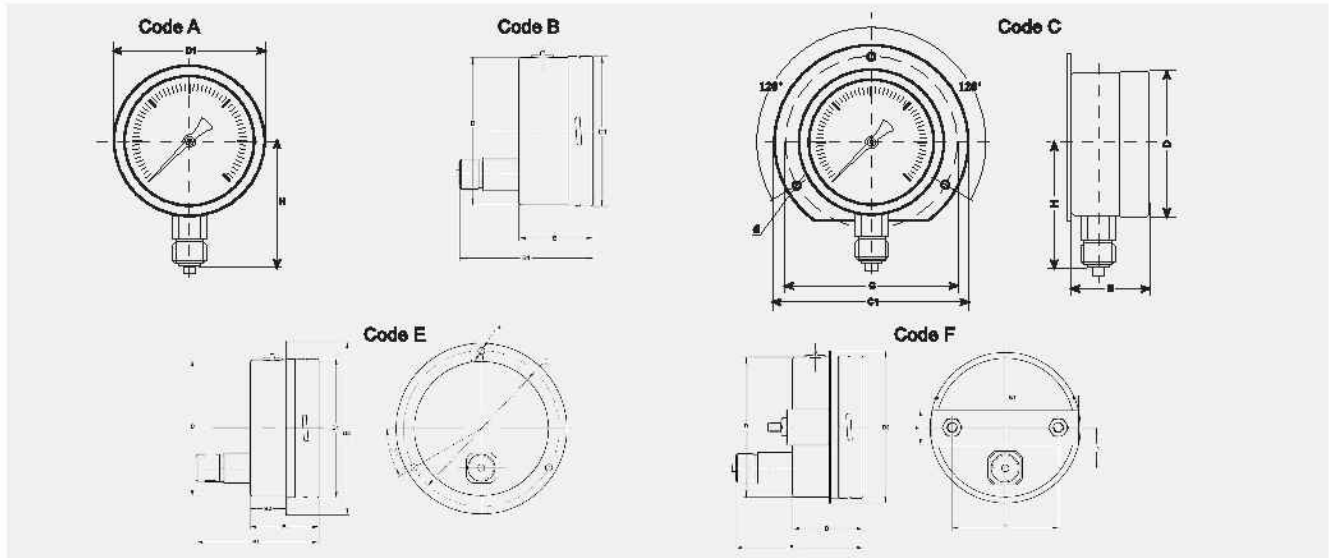

DIAL SIZE	D	D1	D2	D3	H	B	B1	C	C1	E	E1	F	F1	d
2.5"	62	64	85	/	54	34	57	ø77	ø85	/	/	/	/	ø3.5
4"	99	101	128	107.5	83	50	83	ø118.5	ø128	76	76	25.5	29	ø5
6"	147	149	/	/	108	50	83	ø181	ø181	/	/	/	/	ø5

Specification and dimension in this catalogue shown the state of engineering standard at printing period, can be changed without prior notice

How to order:

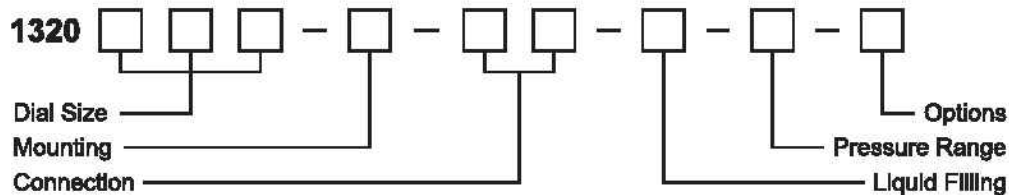

Code Dial Size

063 63mm (2.5")
100 100mm (4")
150 150mm (6")

Code Mounting

A Bottom Connection
B Back Connection
C Bottom Connection with back flange
E Back Connection with front flange
F Back Connection with U-Clamp

Code Liquid Filling

D Dry but fillable
G Glycerine filled
S Silicone oil filled

Code Connection

4 1/4"
2 1/2"
8 1/8"
3 3/8"
N NPT
B BSP B with end stub
T BSPT

Pressure Range

See Standard Pressure Ranges

Options

See options